

DIEGO - TWO TIER - CHANDELIER

INSTALLATION INSTRUCTIONS

1 OF 4

BARONCELLI ⌘



WHAT IS INCLUDED

1. Ceiling canopy
2. Chain
3. Spares
4. Bracket Bar (Junction box attachment)

WHAT YOU WILL NEED

1. Hook / Junction box fixings
2. Bulbs - E14 (240v) / E12 (120v) - Max 60W
3. Screwdriver (3.5mm / 1/8" flat tip) + pliers
4. Soft cloth

DIEGO - TWO TIER - CHANDELIER

INSTALLATION INSTRUCTIONS

2 OF 4

BARONCELLI ⌘

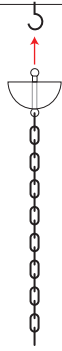

STEP 1

Using a heavy-duty hook secured firmly into a joist, hook the ceiling canopy and chain. Ensure hook is capable of taking a 32kg load.

NOTE: CEILING HOOK IS NOT SUPPLIED



STEP 2

Remove excess chain to determine full drop.

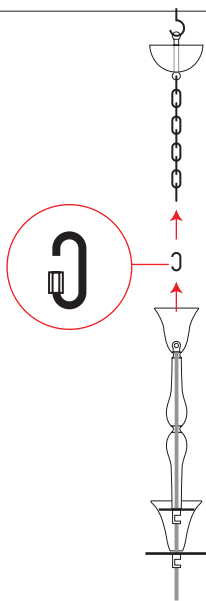

STEP 3

Use shackle to hook the stem to the chain.

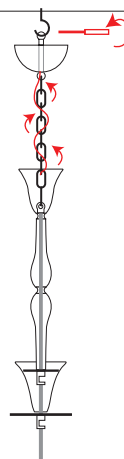

STEP 4

Thread cable up through the length of the stem, thread it through the chain and post up through the tube into the ceiling canopy. Make electrical connection.

DIEGO - TWO TIER - CHANDELIER

INSTALLATION INSTRUCTIONS

3 OF 4

BARONCELLI 

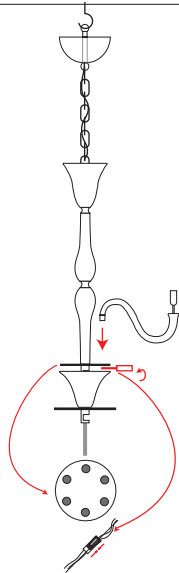

STEP 5

Install arms into their corresponding sockets within the upper fondino plate. Secure into the socket below the plate and make electrical connections using 'click' connectors.

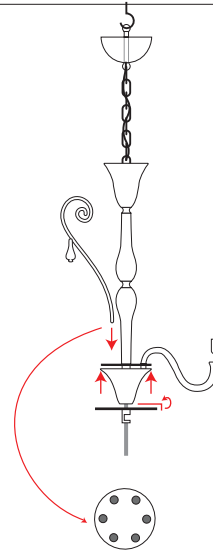

STEP 6

Insert glass elements into top tier fondino plate. Raise upper fondino to cover and secure beneath.

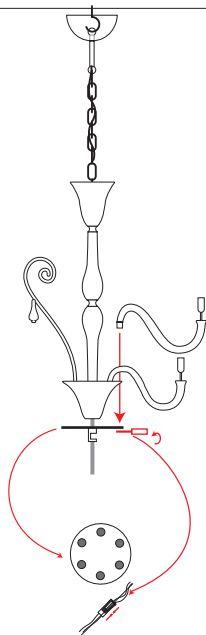

STEP 7

Install arms into lower fondino plate making electrical connections using 'click' connectors and securing beneath the plate.

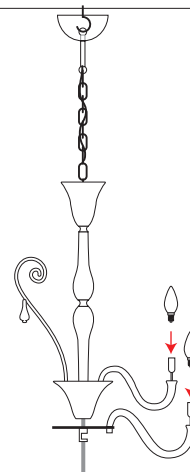

STEP 8

Insert bulbs and test electrics.

DIEGO - TWO TIER - CHANDELIER

INSTALLATION INSTRUCTIONS

4 OF 4

BARONCELLI 

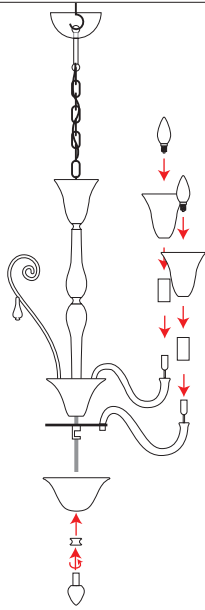

STEP 5

Raise fondino and secure in place using finial components. Attach candle sleeve, cup and bulb.

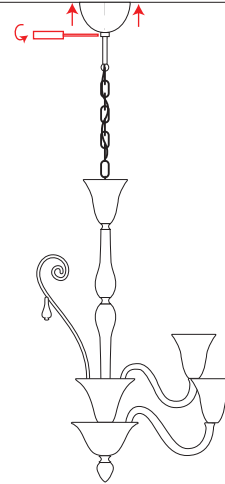

STEP 5

Raise ceiling canopy and secure in place.